

### PINION MATE & SIDE GEAR – NEW SPICER® SERVICE KIT RELEASE

#### PART NUMBER INFORMATION

DATE: May 12, 2023

TO: All Dana Aftermarket Group Spicer® Heavy Axle Customers

**Affected Models:** D & R170(D)/190(D)/590(D), R172(D)

In May & June 2022 for the models listed above, Dana changed the design of the pinion mate and side gear in all current production of drive axles. Changes were made to the beveled teeth.

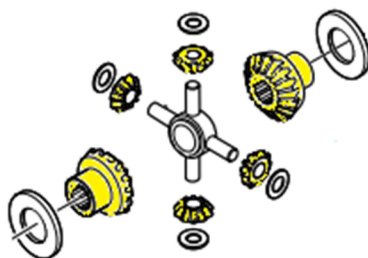

Because of this gear design change, Spicer® side gears and pinion mate gears made before June 8, 2022, (170/190/590) and May 24, 2022 (R172s) will NOT be interchangeable with the newly designed gears. When performing a service repair, it's important to identify when the drive axle was manufactured to ensure you don't mismatch the two different gearing designs. The carrier serial number can be used to determine which gearing is installed. Head assemblies with serial numbers numerically higher than HN08209540 and MY02190155 (for 170/190/590) and HN08203448 and MY02307857 (for R172s) were built on the above dates. Use the chart on the following page to identify the proper service parts to complete your repair.

**Important Note:** If you need to replace one of the two gears on carrier assemblies manufactured before June 8 or May 22, 2022, you must replace both gears with the new design. Mismatching gear designs will cause premature failures that will not be covered under Dana warranty. Because of this, new Spicer® service kits of the new parts are released and presented on page two of this bulletin.



## Individual Parts

<u>Current</u> Dana Part Number (Side Gear)*	<u>Current</u> Dana Part Number (Pinion Mate)*	<u>NEW</u> Dana Part Number (Side Gear)	<u>NEW</u> Dana Part Number (Pinion Mate)	Axle Model(s)
<b>Mating set</b>		<b>Mating set</b>		
300GD101	131040	10166833	10166834	170/190/590
10020053	10020054	10177388	10177389	R172(D)

\* These items will be available while quantities last

## New Service Kits

New Dana KIT Part Number	Component Part Number	Quantity /Kit	Axle Model(s)
505327	10166833	2	170/190/590
	10166834	4	
505328	10177389	4	R172(D)
	10177388	2	

## New Kits, with Bill of Materials

New KIT Part Number	New KIT BOM	Quantity/ Kit	Description	Axle Model(s)
513868-1	10166833	2	GEAR-SIDE	D/R170(D), 190(D), 590(D), S170E, 190D, 190DE
	10166834	4	PINION SIDE	
	131039	1	SPIDER - DIFF	
504096-1	10166833	2	GEAR-SIDE	D/R170(D)
	10166834	4	PINION SIDE	
	131039	1	SPIDER - DIFF	
	300HS100-1	4	S/P THRUST WASHER	
	HS108-1	2	S/G THRUST WASHER	
504371-1	10021339	2	DIFFERENTIAL SHAFT (SHORT PIN)	R172(D)
	10019723	1	DIFFERENTIAL SHAFT (LONG PIN)	
	083726	1	THRUST WASHER	
	10019998	4	THRUST WASHER	
	10021349	2	DOWEL PIN	
	10177389	4	S172D - SIDE PINION	
	10177388	2	S172D - SIDE GEAR	

If you need additional information, please contact your Dana Aftermarket representative.

Peter Hough

Product Manager  
Spicer® Heavy Axle Products

HD AXLE INFO